

<<:Project Photo 2>>

<<:Project Photo 3>>

<<:Project Photo 4>>

<<TITLE>>

<<LOCATION>> | \$<<COST (\$) >> | <<SIZE (SF)>> SF |  
<<COMPLETION DATE (MO & YEAR)>>  
<<Description>>

Icons to Add:

- <<Icon 1>>
- <<Icon 2>>
- <<Icon 3>>
- <<Icon 4>>

- <<Icon 5>>
- <<Icon 6>>
- <<Icon 7>>
- <<Icon 8>>
- <<Icon 9>>

<<Icon 10>>

OWNER

<<Owner Entity>>  
 <<Owner Name>>  
 <<Title1>>  
 <<Owner Phone>>  
 <<Owner Email>>

ARCHITECTS

<<Arch. Entity>>  
 <<Arch. Name>>  
 <<Arch. Title>>  
 <<Arch. Phone>>

TEAM MEMBERS

- <<Team Member 1>>, <<Title 1>>
- <<Team Member 2>>, <<Title 2>>
- <<Team Member 3>>, <<Title 3>>
- <<Team Member 4>>, <<Title 4>>
- <<Team Member 5>>, <<Title 5>>
- <<Team Member 6>>, <<Title 6>>
- <<Team Member 7>>, <<Title 7>>

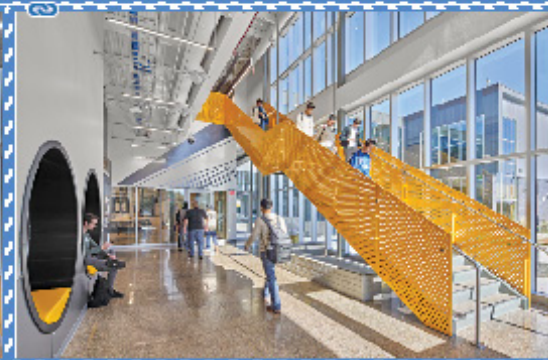
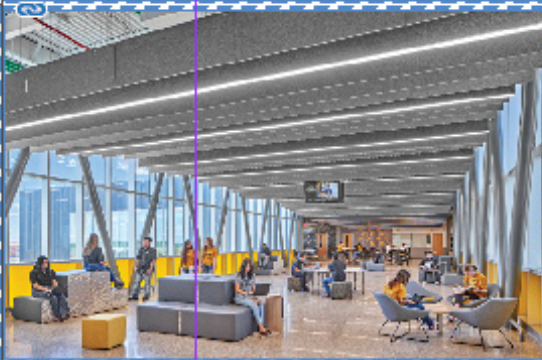

**CAREER & TECHNICAL EDUCATION CENTER OF HOBBS (CTECH)**

HOBBS, NM | \$34.4M | 86,600 SF |

The new Career & Technical Education Center of Hobbs (CTECH) will house a robust variety of technical programs to support the growing population of the existing High School. This facility will supplement students' core classes with hands on training and education that will prepare them for future education and careers. Disciplines

Icons to Add:  
 CM at Risk  
 Educational

Active Campus  
 SE New Mexico  
 Common Core Team Members

**OWNER**  
 [Redacted] Schools  
 Gene [Redacted]  
 575. [Redacted]  
 st [Redacted]@ [Redacted]ols.net

**ARCHITECTS**  
 [Redacted] Architecture  
 Barry [Redacted]  
 512. [Redacted]

**TEAM MEMBERS**

- Luke [Redacted] Sr. PM
- John [Redacted] Safety Director
- Rich [Redacted], BIM
- Lawrence [Redacted] Precon
- Dennis [Redacted] President
- ,
- ,

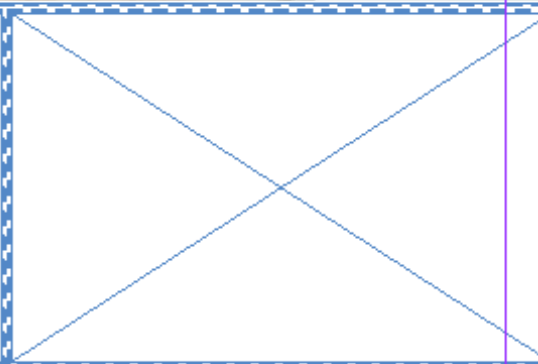
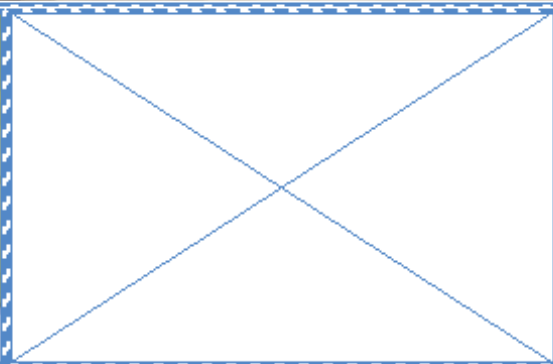
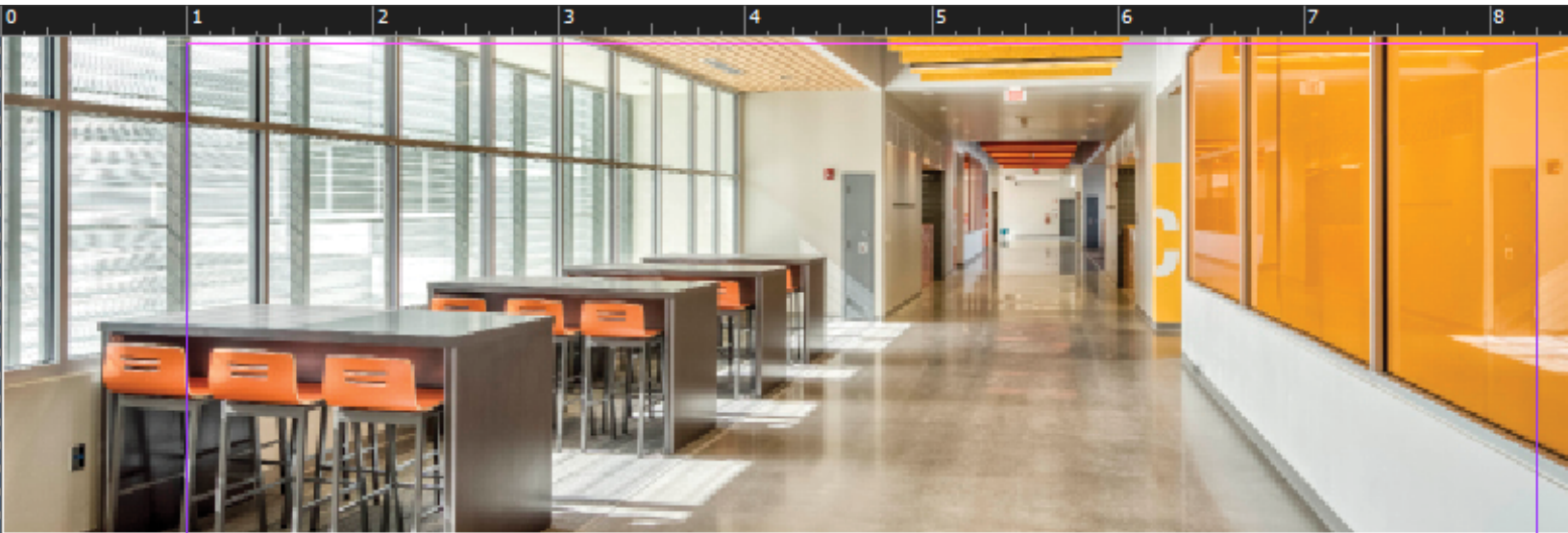

JULY 24, 2018”

ONE OF THE LARGEST CHALLENGES FOR THIS PROJECT WAS THE EXTREME VOLUME OF WORK TO BE COMPLETED IN A RELATIVELY SHORT TIME. THIS PROJECT INCLUDED A FAIRLY COMPLEX DESIGN WITH MANY DIFFERENT TYPES OF FINISHES INCLUDING EXTERIOR FINISHES OF MASONRY, EXPOSED CONCRETE, AND SEVERAL DIFFERENT TYPES OF METAL PANELS.

Icons to Add:  
LEED  
50,000 sf +  
Common Core Team

Educational/K-8 School  
Tres Volcanes Community  
Collaborative School  
Schools

Karen  
Exec. Director of Facilities

**OWNER**  
A Architecture  
James & Dean  
Principals & Co-Owners  
505.

**ARCHITECTS**  
Lawrence  
Const. Mgr.  
Dan  
Sr. Project Manager

**TEAM MEMBERS**

- General Supt., Darren
- n, Supt.
- Taylor, Asst. PM
- John, Safety Director
- Frank, Quality Control
- Margaret Project Tech
- ,

A	B	C	D	E	F	G	H	I	J	K
Title	Location	Size (sf)	Cost (\$)	Completion Date (Mo & Year)	Duration	Challenges	Preconstruction	Description	@:Project Photo 1	@:Project Photo 2
Career & Technical Education Center of Hobbs (CTECH)	Hobbs, NM	86,600	34.4M		668 Days August 31, 2020 - June 30, 2022		CM at Risk. Estimates. Schedules. Consultants.	The new Career & Technical Education Center of Hobbs (CTECH) will house a robust variety of technical programs to support the growing population of the existing High School. This facility will supplement students' core classes with hands on training and education that will prepare them for future education and careers. Disciplines supported include energy, manufacturing/ machining, construction (general/carpentry, electrical and HVACR), architectural design, welding, automotive repair and maintenance, heavy vehicle repair and maintenance, information technology, robotics and culinary arts.	C:\Users\jundersar C:\Users\jundersar	C:\Users\jundersar C:\Users\jundersar
Tres Volcanes Community Collaborati	Albuquerque	216,996	47.7M	July 2018	588 Days December 12, 2016 - July 24, 2018	One of the largest	Estimating. The project	New K-8 school comprised of 74 classrooms, shared gym, shar	C:\Users\jundersar C:\Users\jundersar	C:\Users\jundersar C:\Users\jundersar

C10 : X ✓ f<sub>x</sub>

K	L	M	N	O	P	Q	R	S	T	U	V	W	X	Y
Owner Entity	Owner Name	Title	Owner Phone	Owner Email	Arch. Entity	Arch. Name	Arch. Title	Arch. Phone	Arch. Em					
Schools	Gene		575	s@schools.net	Architecture	Barry		512	c.com					
Pu Karen		Exec. Director of	505	a@.edu	Architecture	James	DePrincipals & Co-Ov	505						