

FEATURES

- Slim, Lightweight, 3-Piece Versatile Volumetric Selectable Troffer Retrofit Kit allowing for quick, easy and simple installation
- Slim Depth of 2.1", allowing for installation into a wide array of ceiling applications
- Available in 1x4, 2x2, & 2x4 Sizes with a Lumen Range from 2,000 to 5,000 Lumens
- CCT and Lumen Field Selectable, with optional factory settings for customized ambiance and application
- High Efficacy (Up to 146 LPW) provides lower operational costs compared to traditional fluorescent fixtures
- Advanced Control Options Available, Enables flexible lighting control and additional energy savings
- Buy American Act (BAA) option available

DIGITAL NAVIGATION

Explore the spec sheet through the links below

[ORDERING GUIDE](#)
[QUICK SHIP](#)
[LED SYSTEMS TABLE](#)
[CONTROLS](#)
[LINE DRAWINGS](#)

SUITABLE APPLICATIONS

- Education
- Healthcare
- Offices
- Grocery Store
- Retail
- Storage Facility
- Residential
- Stairwell

CERTIFICATIONS



SPECIFICATIONS

CONSTRUCTION

A Post Painted Sleek Steel housing body for rigidity, durability, and ease of installation. Designed for maximum rigidity and durability. One-piece unit with two universal mounting brackets for quick and easy installation into grid.

ELECTRICAL

Class 2 LED light engine for high efficacy and long life. Calculated L70 > 100,000 hrs. LED Lumen Maintenance Estimates based on TM-21 projections for the light source at 25°C ambient. Power Factor > 0.90. Standard 120-277 Vac 0-10V dimmable (10%-100%) with optional 1%, Sensor Ready, & Bi-Level Driver options available. Optional emergency battery backups available to meet critical life safety lighting requirements.

TROFFER COMPATIBILITY & INSTALLATION

VTK is designed to fit into most existing parabolic and lensed troffers with a housing depth of 3 1/8" or greater. ILP recommends a test installation prior to ordering project quantities. Contact factory for additional troffer compatibility confirmation. One-piece door frame light engine with two universal mounting brackets for easy installation. See page 3 for step-by-step troffer kit installation instructions.

CONTROLS

Factory installed Advanced sensor options available. Sensor mounts within the body of the fixture. View controls page for more detail (pg.4). Inquire with manufacturer for additional controls options, including customer supplied items.

CERTIFICATIONS

ETL Listed to US & Canadian safety standards. ETL Listed for UL1598C. Suitable for damp locations. Buy American Act (BAA) Compliant Option Available. Suitable for damp locations. Title 24 Compliant with sensor option; see local ordinance for qualification information.

WARRANTY

5 Year Warranty Standard; 10 Year Warranty Optional (Terms and Conditions apply).



ORDERING GUIDE

PART #

Example: VTK22-2L/3L/4L-U-CCTS-BAA

SERIES		LUMENS		DRIVER		CCT		BAA	
VTK14	1x4 Volumetric Troffer Kit	2L/3L/4L - Lumen Selectable	2L 3L 4L	U ⁴	120-277V	CCTS	Selectable CCT (3500K, 4000K, 5000K)	BLANK	None
VTK22	2x2 Volumetric Troffer Kit	2L/3L/4L - Lumen Selectable	2L 3L 4L			35	3500K	BAA ⁵	BAA Compliant
VTK24	2x4 Volumetric Troffer Kit	3L/4L/5L - Lumen Selectable	3L 4L 5L			40	4000K		
						50	5000K		

OPTIONS	
FACTORY INSTALLED	
BLANK	None
SR ²	Sensor-Ready Driver
DR ²	Dali-Ready Driver
BLD ²	Bi-Level Dimming Driver
DIM1 ²	1% Dimming Driver
EM5	5W LED Factory Installed Battery Backup
EM5/HE	5W LED Factory Installed Battery Backup CEC Title 20 Compliant
EM7	7W LED Factory Installed Battery Backup
EM7/HE	7W LED Factory Installed Battery Backup CEC Title 20 Compliant
EM10	10W LED Factory Installed Battery Backup
EM10/HE	10W LED Factory Installed Battery Backup CEC Title 20 Compliant
EM10/HE/SD	10W LED Factory Installed Self-Diagnosing Battery Backup CEC Title 20 Compliant
EM12	12W LED Factory Installed Battery Backup

CONTROLS	
ADVANCED	
BLANK	None
ESMC ^{2,3}	EasySense Grouping Sensor
5E/CU/CL	Enlighted 5E Connected Lighting (CL) Sensor w/ Control Unit
5E/CU/IOT	Enlighted 5E Internet of Things (IOT) Sensor w/ Control Unit
VDO ^{1,2}	Lutron Vive Daylight & Occupancy Sensor
VRF ^{1,2}	Lutron Vive Radio Frequency Only
AWNR ^{1,2}	Lutron Athena Wireless Node RF Only
AWNS ^{1,2}	Lutron Athena Wireless Node with Sensor

WARRANTY	
BLANK	5 Year
10YR ⁵	10 Year

SHIP WITH ACCESSORIES	
BLANK	None
ESMC/WWS/DR	EasySense Dual Rocker Wireless Wall Switch

FOOTNOTES

¹ Must be used with SR Sensor Ready Driver

² Not compatible with the Lumen selectable and CCT selectable functions. Must select dedicated Lumen and CCT options.

³ Requires Bluetooth enabled device for programming (provided by others)

⁴ Standard 120-277V Driver Dimmable Down to 10%

⁵ Contact factory for more details



QUICK SHIP ITEMS

PRODUCT	DESCRIPTION	UPC CODE	DLC LISTING
VTK14-2L/3L/4L-U-CCTS	Volumetric Troffer Kit 1x4, Lumen Selectable -2,465 - 3,190 - 3,770lm, CCT Selectable -35-40-50K		
VTK22-2L/3L/4L-U-CCTS	Volumetric Troffer Kit 2x2, Lumen Selectable -2,465 - 3,190 - 3,770lm, CCT Selectable -35-40-50K		
VTK24-3L/4L/5L-U-CCTS	Volumetric Troffer Kit 2x4, Lumen Selectable -3,190 - 3,770 - 4,640lm, CCT Selectable -35-40-50K		

SYSTEMS INFO ^{1,3}		3500K CCT		4000K CCT		5000K CCT		Watts ²
Part Numbers	Fixed Model Numbers	Lumens	LPW	Lumens	LPW	Lumens	LPW	
VTK14-2L/3L/4L	VTK14-2L	2465	145	2482	146	2465	145	17
	VTK14-3L	3190	145	3212	146	3190	145	22
	VTK14-4L	3770	145	3796	146	3770	145	26
VTK22-2L/3L/4L	VTK22-2L	2465	145	2482	146	2465	145	17
	VTK22-3L	3190	145	3212	146	3190	145	22
	VTK22-4L	3770	145	3796	146	3770	145	26
VTK24-3L/4L/5L	VTK24-3L	3190	145	3213	146	3190	145	22
	VTK24-4L	3770	145	3797	146	3770	145	26
	VTK24-5L	4640	145	4672	146	4640	145	32

¹LED Chips are frequently updated therefore values are nominal

³Preliminary test data

²Electrical data at 25°C (77°F) 277V. Actual wattage may differ by +/-10%.

INSTALLATION INSTRUCTIONS

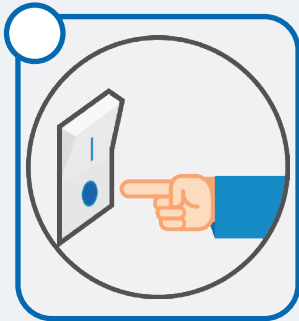

STEP 1

Shut off or disconnect power to the fixture.

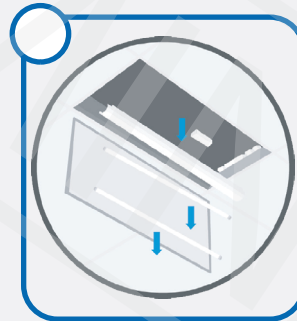

STEP 2

Remove existing fluorescent lamps and components, then disconnect existing connections to the fluorescent ballast.

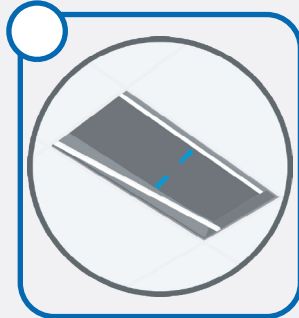

STEP 3

Gently lift the original housing and insert the brackets between the housing and the T-grid. Allow the housing to rest on the brackets, securing them in place. Optional tether included on the mounting brackets to secure the kit to the housing.

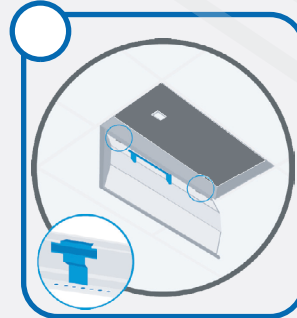

STEP 4

Hang the VTK body by hooking the T-hinges into the respective slots in the bracket.

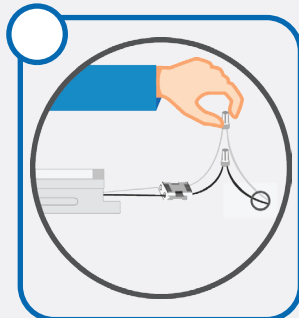

STEP 5

Connect the VTK to AC power and ground.

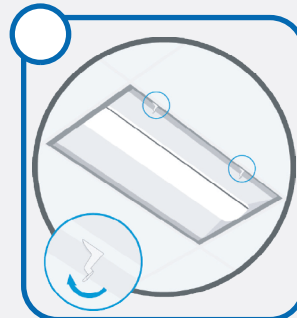

STEP 6

Rotate the VTK body up into the fixture and close the latches. Turn on or reconnect power to the fixture to complete the installation.



ADVANCED CONTROLS OPTIONS

EASYSense

ESMC

EasySense sensor combines occupancy sensing, daylight harvesting and institutional tuning in one compact solution. This is an ideal control for any Commercial application. Each device allows you to turn on/off occupancy and/or daylight harvesting functions as well as set the full light output, background light level, occupancy prolong time, occupancy grace fading time & occupancy time out/ hold time. It can be easily controlled via the Philips MasterConnect Bluetooth App on a mobile phone.



ESMC/WWS/DR

Optional Wireless / Batteryless Dual Rocker Wall Switch. Up to 100ft range. Functions include: On/Off, dimming and setting of (2) scenes for full room control.

Specifications:

- Wireless
- Batteryless
- Dual Rocker
- ZigBee®
- 30-100ft Range

Functions:

1. On (Hold to brighten up)
2. Off (Hold to dim down)
3. Scene 1
4. Scene 2



ENLIGHTED

5E/CU/CL

Bundled System with Enlighted 5E sensor (SU-5E-CL), Control Unit (CU-4E-FM) and Cable (CBL-5E-CU4-30N). Fixtures are controlled based on occupancy and ambient light. Includes individual lighting control plus connection to Enlighted Energy Manager. The Energy Manager provides data analysis for all data collected by the Enlighted Smart Sensors for energy, occupancy and environment. Provided with factory installed components only. Enlighted system provided by others. Contact factory for more information.



5E/CU/IOT

Bundled System with Enlighted 5E sensor (SU-5E-IOT), Control Unit (CU-4E-FM) and Cable (CBL-5E-CU4-30N). Fixtures are controlled based on occupancy and ambient light. Includes individual lighting control plus connection to Enlighted Energy Manager. Energy Manager provides data analysis for all data collected by Enlighted Smart Sensors for energy, occupancy & environment. Additionally, the IOT functionality takes the data access and function beyond just lighting to a wide range of applications beyond the standard connected lighting controls. Provided with factory installed components only. Enlighted system provided by others. Contact factory for more information.

LUTRON

VDO

Vive DFCSJ-OEM-OCC integral fixture control sensor with daylight & occupancy. Vive provides intuitive programming allowing for maximum flexibility with wireless communication & sensing as desired. Provided with factory installed components only. Lutron system provided by others. Sensor must be used in conjunction with Pico Switch/Dimmer. Cannot be used in conjunction with mechanical on/off power switch. Contact factory for more information.



AWNR

Athena wireless node is a radio frequency (RF) device that enables simple, digital control of individual light fixtures in an Athena control system. Enables individual wireless control of each fixture in an Athena control system. Accommodates zone and control changes without rewiring. All drivers on the link are controlled as a single zone. Provided with factory installed components only. Lutron Athena system provided by others.



VDO

Vive DFCSJ-OEM-RF integral fixture control with Radio Frequency (RF) communication. Vive provides intuitive programming allowing for maximum flexibility with wireless communication as desired. Provided with factory installed components only. Lutron system provided by others. Sensor must be used in conjunction with Pico Switch/Dimmer. Cannot be used in conjunction with mechanical on/off power switch. Contact factory for more information.



AWNS

Athena wireless node with a sensor that enables simple, digital control of individual light fixtures in an Athena control system. Provides wireless control of the fixture and includes a passive infrared (PIR) sensor for occupancy and a daylight sensor. Enables individual wireless control of each fixture in an Athena control system. Accommodates zone and control changes without rewiring. All drivers on the link are controlled as a single zone. Provided with factory installed components only. Lutron Athena system provided by others.





LINE DRAWINGS

VTK 1x4

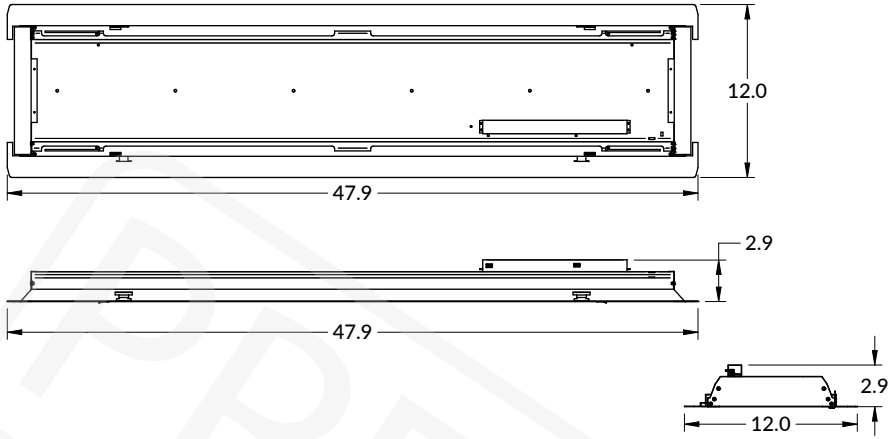

VTK 2x2

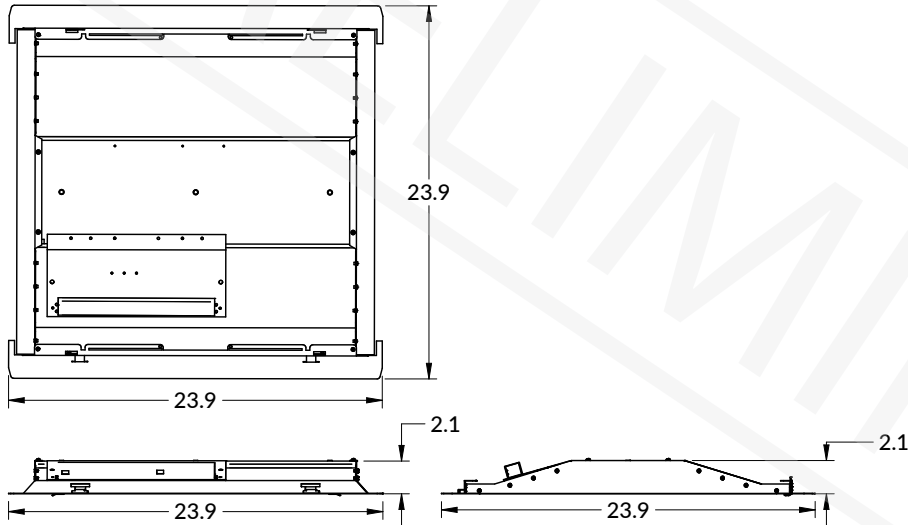

VTK 2x4

